



Digital Commons@

Loyola Marymount University
LMU Loyola Law School

Honors Thesis

Honors Program

5-4-2016

“Vania, and Sonia and Masha and Spike” Technical Direction

Thomas Ash

thomas.c.ash42@gmail.com

Follow this and additional works at: <https://digitalcommons.lmu.edu/honors-thesis>



Part of the [Other Theatre and Performance Studies Commons](#)

Recommended Citation

Ash, Thomas, ““Vania, and Sonia and Masha and Spike” Technical Direction” (2016). *Honors Thesis*. 124. <https://digitalcommons.lmu.edu/honors-thesis/124>

This Honors Thesis is brought to you for free and open access by the Honors Program at Digital Commons @ Loyola Marymount University and Loyola Law School. It has been accepted for inclusion in Honors Thesis by an authorized administrator of Digital Commons@Loyola Marymount University and Loyola Law School. For more information, please contact digitalcommons@lmu.edu.



“Vania, and Sonia and Masha and Spike” Technical Direction

A thesis submitted in partial satisfaction
of the requirements of the University Honors Program
of Loyola Marymount University

by

Thomas Ash

5-4-2016

*All Plans Not to Scale

VANYA & SONIA & MASHA & SPIKE
LMU - BARNELLE THEATRE

DIR. DANA RESNICK
DES. T. JEFFERS

PRELIM GPLAN, 1/4" SCALE
DATE: 11/13/15

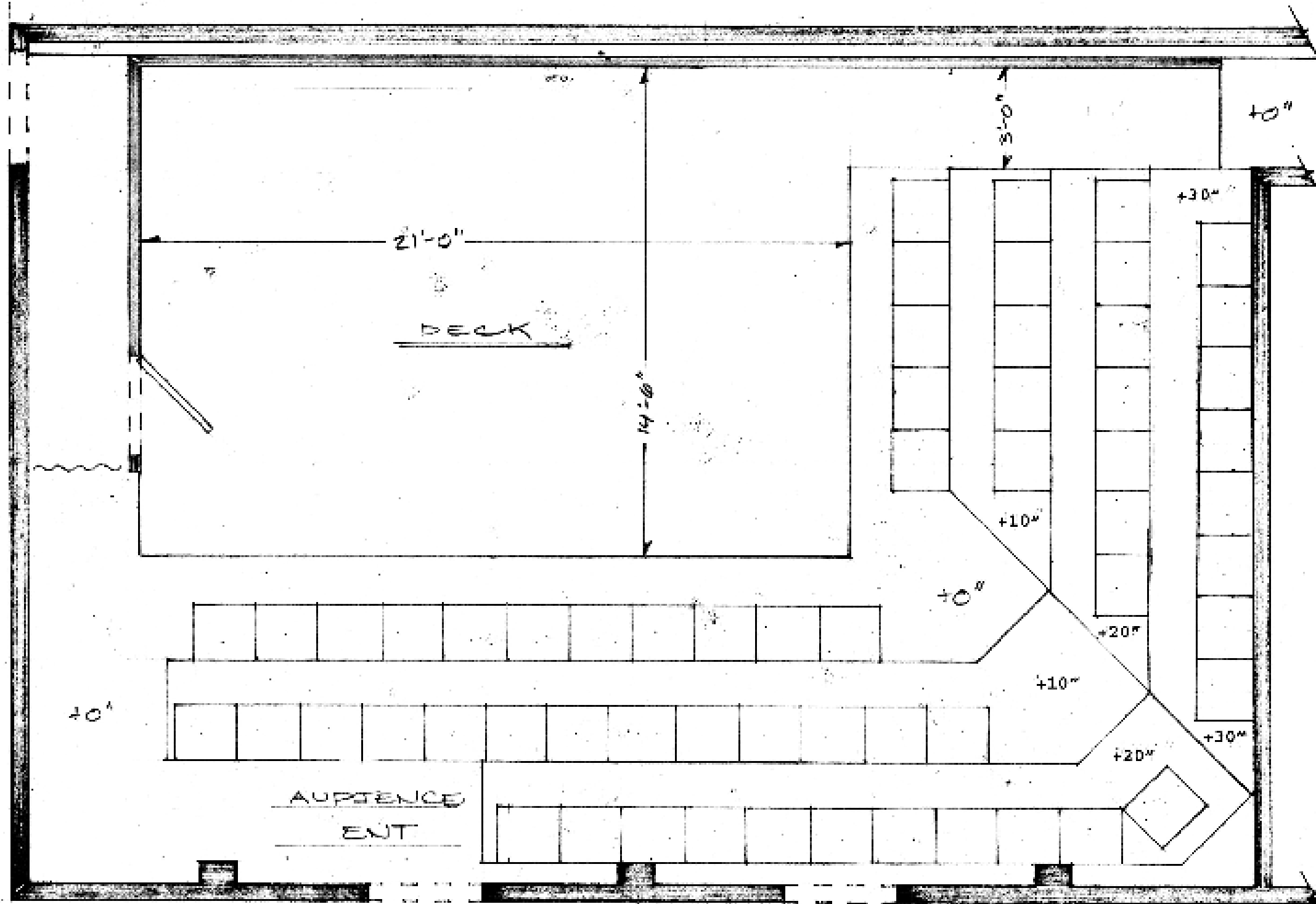

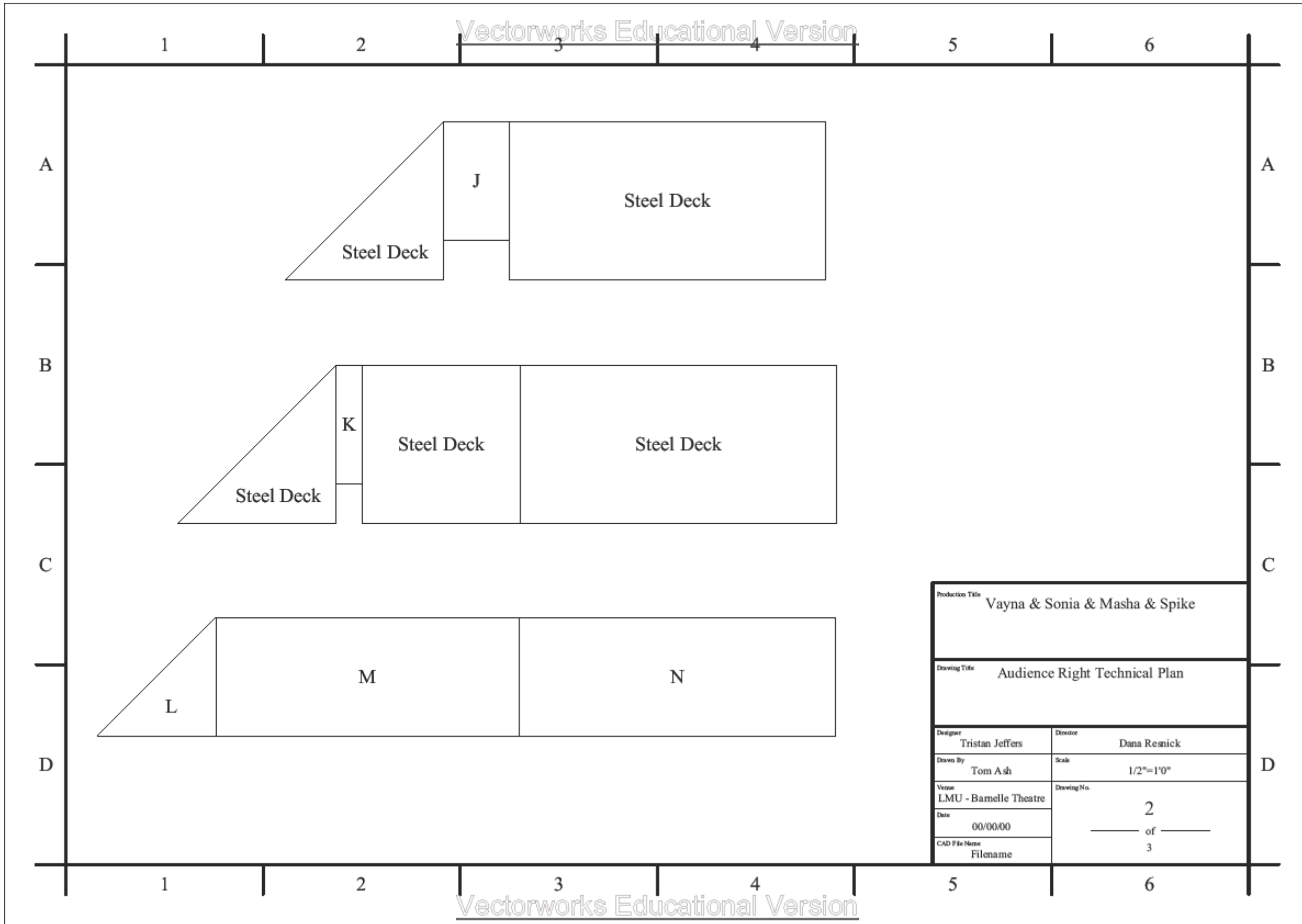

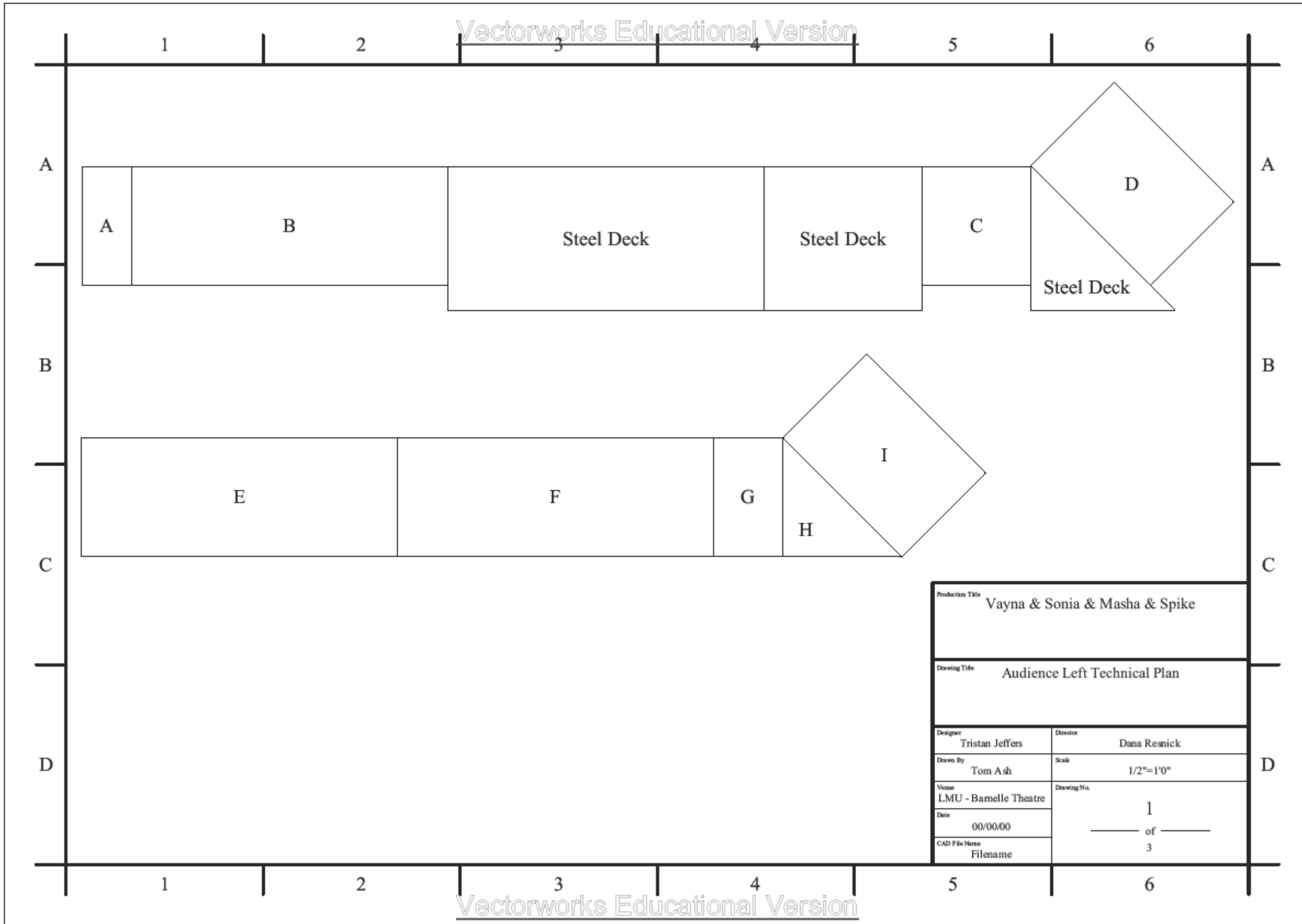

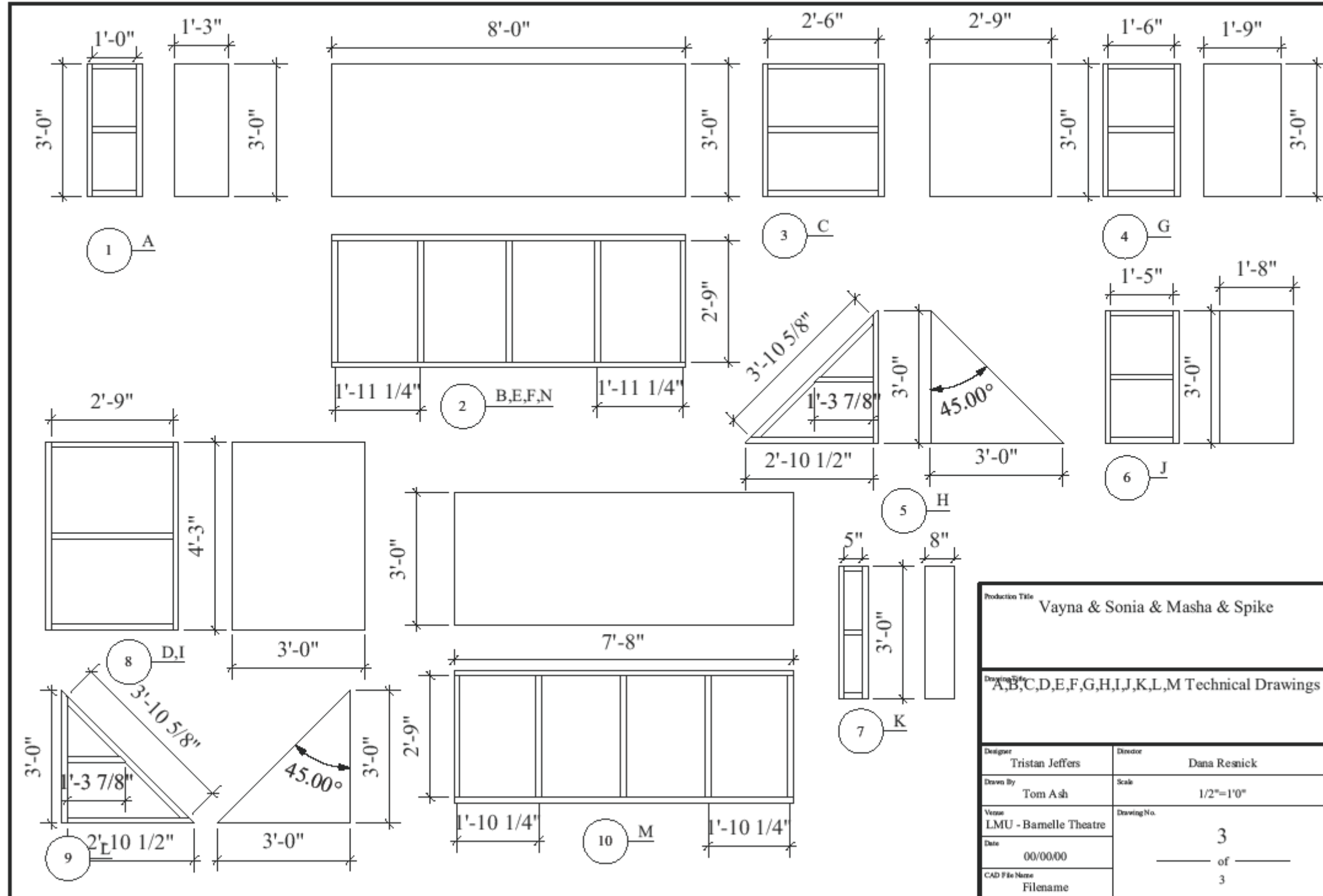

Production Title		Vayna & Sonia & Masha & Spike	
Drawing Title			
A,B,C,D,E,F,G,H,I,J,K,L,M Technical Drawings			
Designer	Tristan Jeffers	Director	Dana Resnick
Drawn By	Tom Ash	Scale	1/2"=1'0"
Viewer	LMU - Barnelle Theatre	Drawing No.	3
Date	00/00/00		_____ of _____
CAD File Name	Filename		3

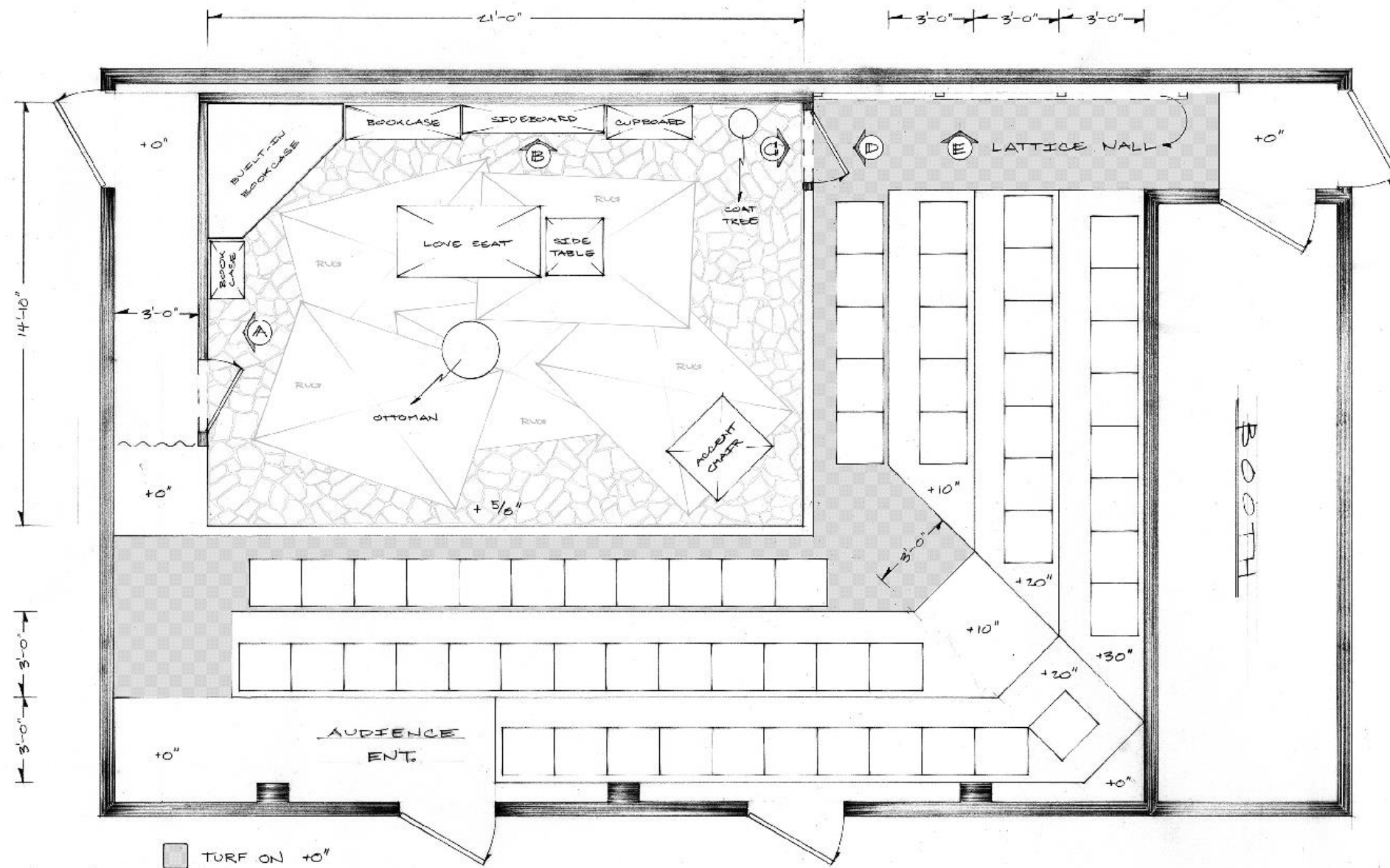

PLAN

VANYA + SONIA + MASHA + SPIKE	
LNU - BARNHILL THEATRE	
DATE:	12.15.15
SCALE:	3/8" = 1'-0"
SHEET:	1 of 5
DESIGNER:	DANA RESNICK
REVISOR:	T. JEFFERS
<u>PLAN</u>	

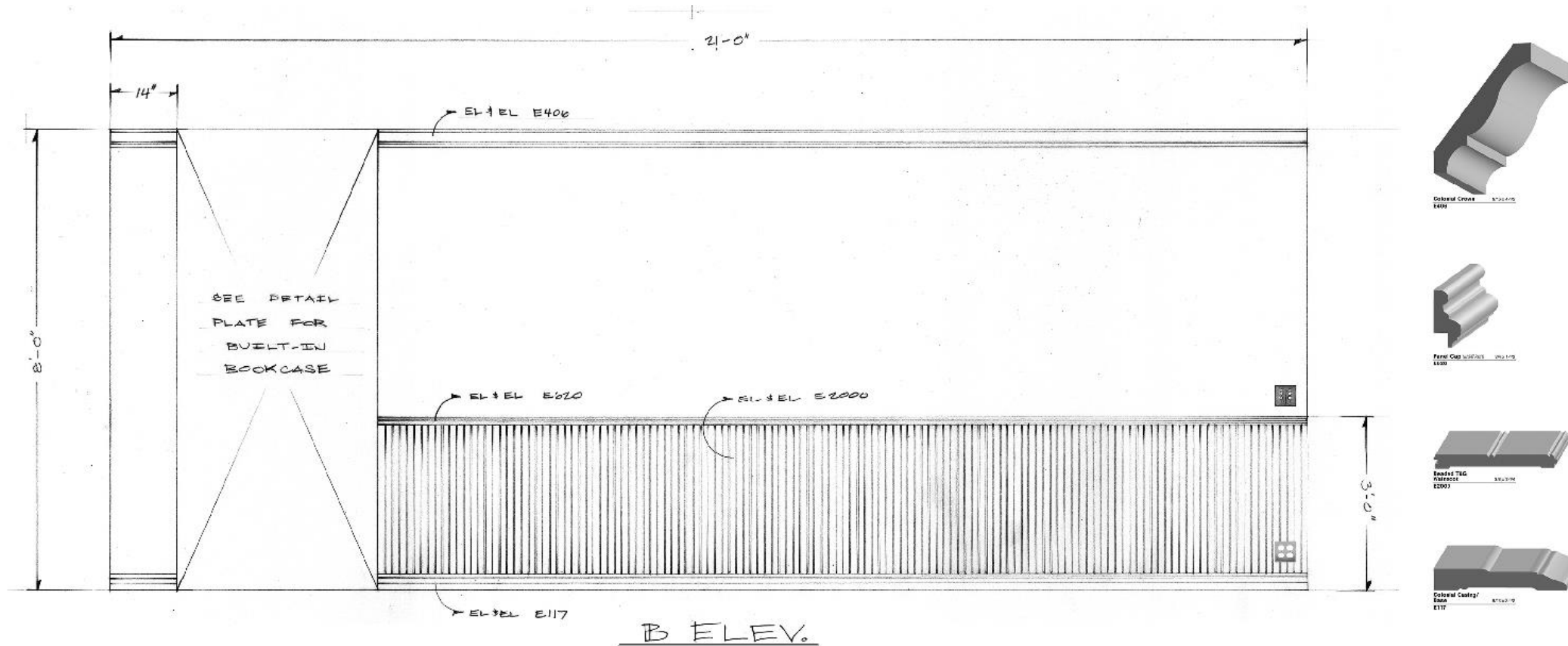

B ELEV.

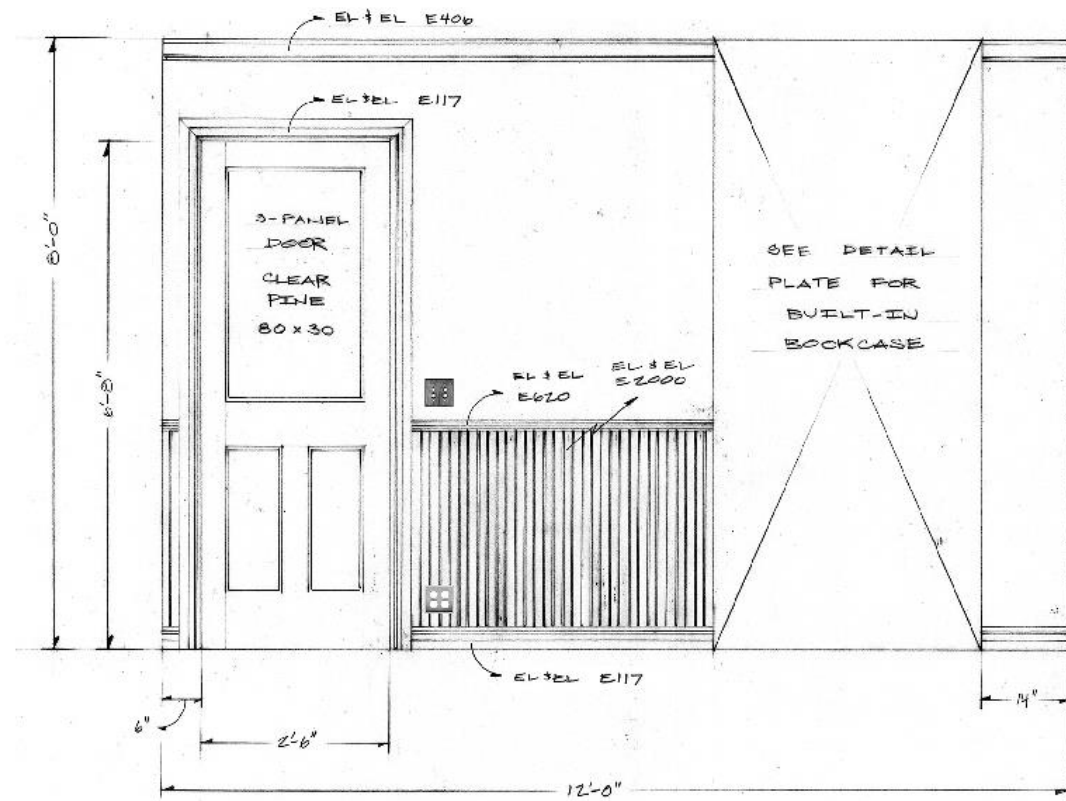

A ELEV.

NOTES:

1. WALLPAPER OF A, B, & C IS TBD.
2. ALL MOULDING, WAINSCOT, & DOORS SHOULD BE CLEAR PINE, AND PREPPED FOR STAIN AND POLY (SHADES AND GLOSS TBD).
3. LIGHTSWITCHES ARE THE PUSH-BUTTON TYPE, AGED BRASS PATINA.
4. PERHAPS AN OUTLET ABOVE THE SIDEBOARD, EXACT LOCATION TBD.
5. DISCUSS DOOR HARDWARE

VANYA + SONIA + MASHA + SPIKE	
LMU - BARNHILLE THEATRE	
DATE:	A + B ELEV'S.
12.15.15	
SCALE:	2 of 5
3/4" = 1'-0"	
SHEET:	DIR: DANA RESNICK
2 of 5	DES: T. JEFFERS

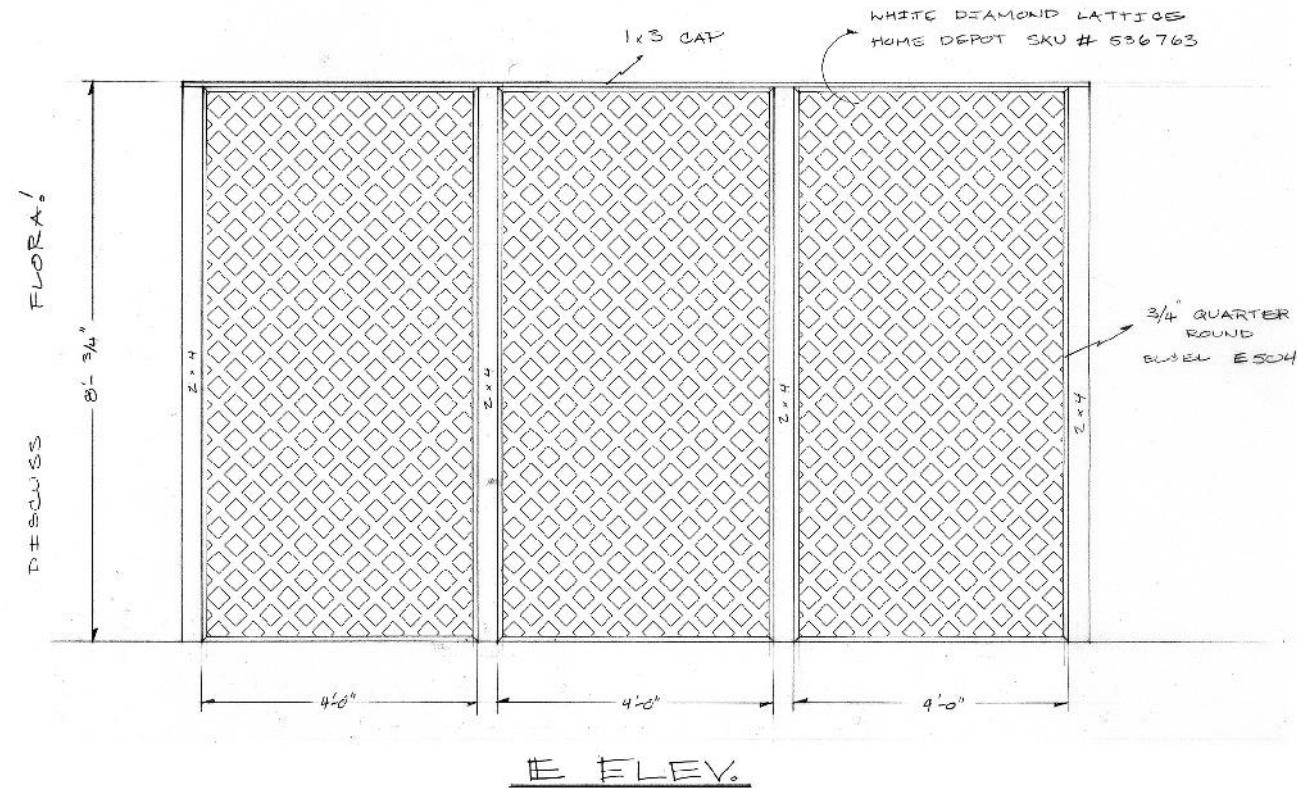

NOTES:

1. DOOR SHOULD HAVE GLASS IN ITS TOP HALF WITH PANELING BELOW. I PREFER A DIAMOND MUNTIN PATTERN, BUT WE SHOULD SEE WHAT IS AVAILABLE.
2. EXTERIOR DOOR SHOULD BE FLUSH WITH D'S SURFACE.
3. SHINGLES SHOULD BE A DISTRESSED, WEATHERED GRAY.
4. TRIM ON D, AS WELL AS LATTICE WALL E SHOULD BE PAINTED WHITE (GLOSS LEVEL TBD), WITH SOME WEATHERING.

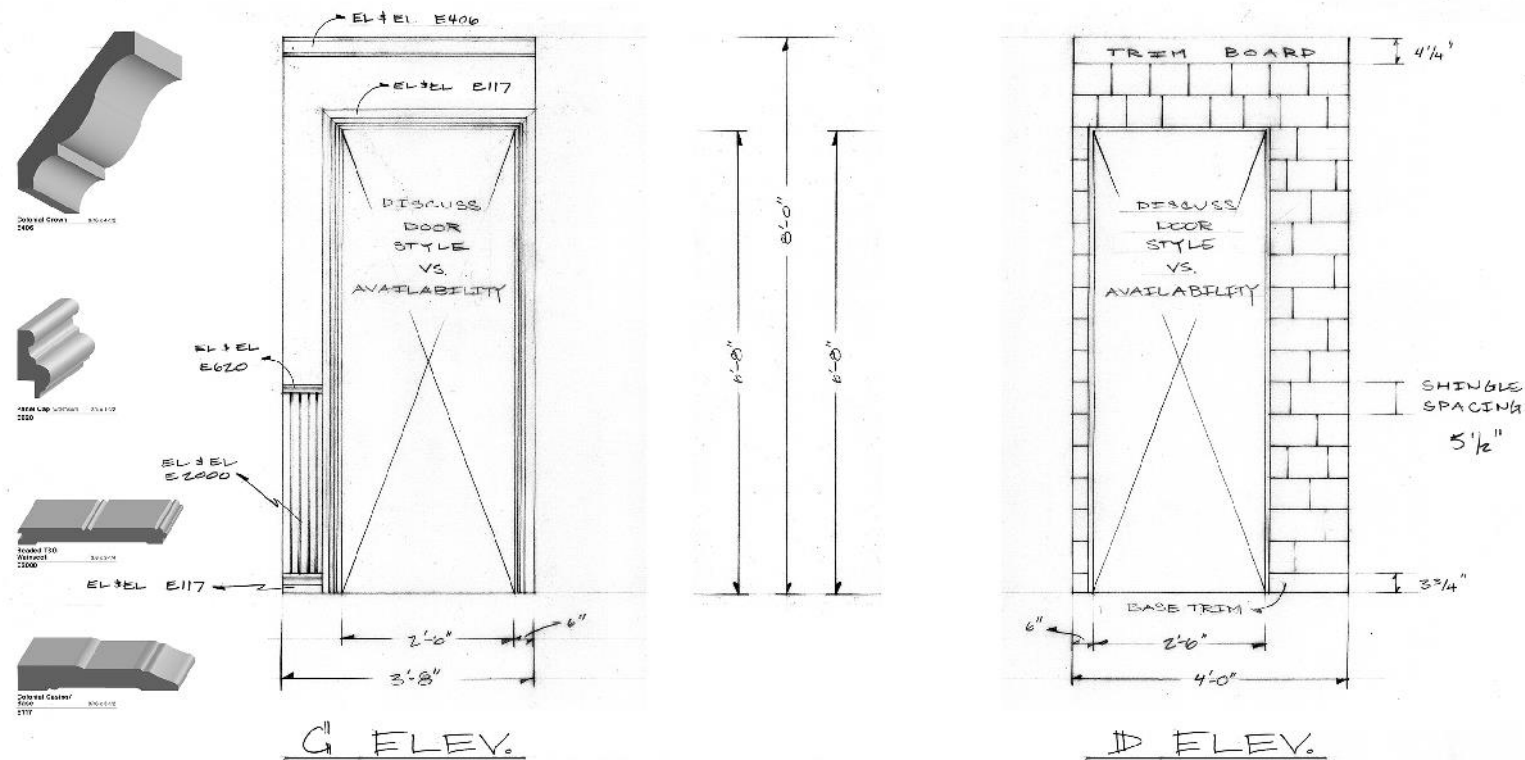

VANYA + SONIA + MASHA + SPIKE	
LHO - BARNHILL THEATRE	
DATE: 12.15.15	C, D, & E ELEVATIONS
SCALE: 3/4" = 1'-0"	
SHEET: 3 of 5	DIR: DANA RESNICK DES: T. JEFFERS

NOTES: I'm proposing that the method for making the flagstone treatment is:

- 1) Cut 1/2" homasote into the approximate shapes drawn.
- 2) Use joint compound to provide the flagstones with some texture.
- 3) Paint each stone with a scumble/spatter, possibly seal.
- 4) Lay out and adhere to 1/8" masonite with gaps between.
- 5) Use grout or colored JC or similar to fill the gaps.
- 6) Seal the floor, level of gloss TBD.

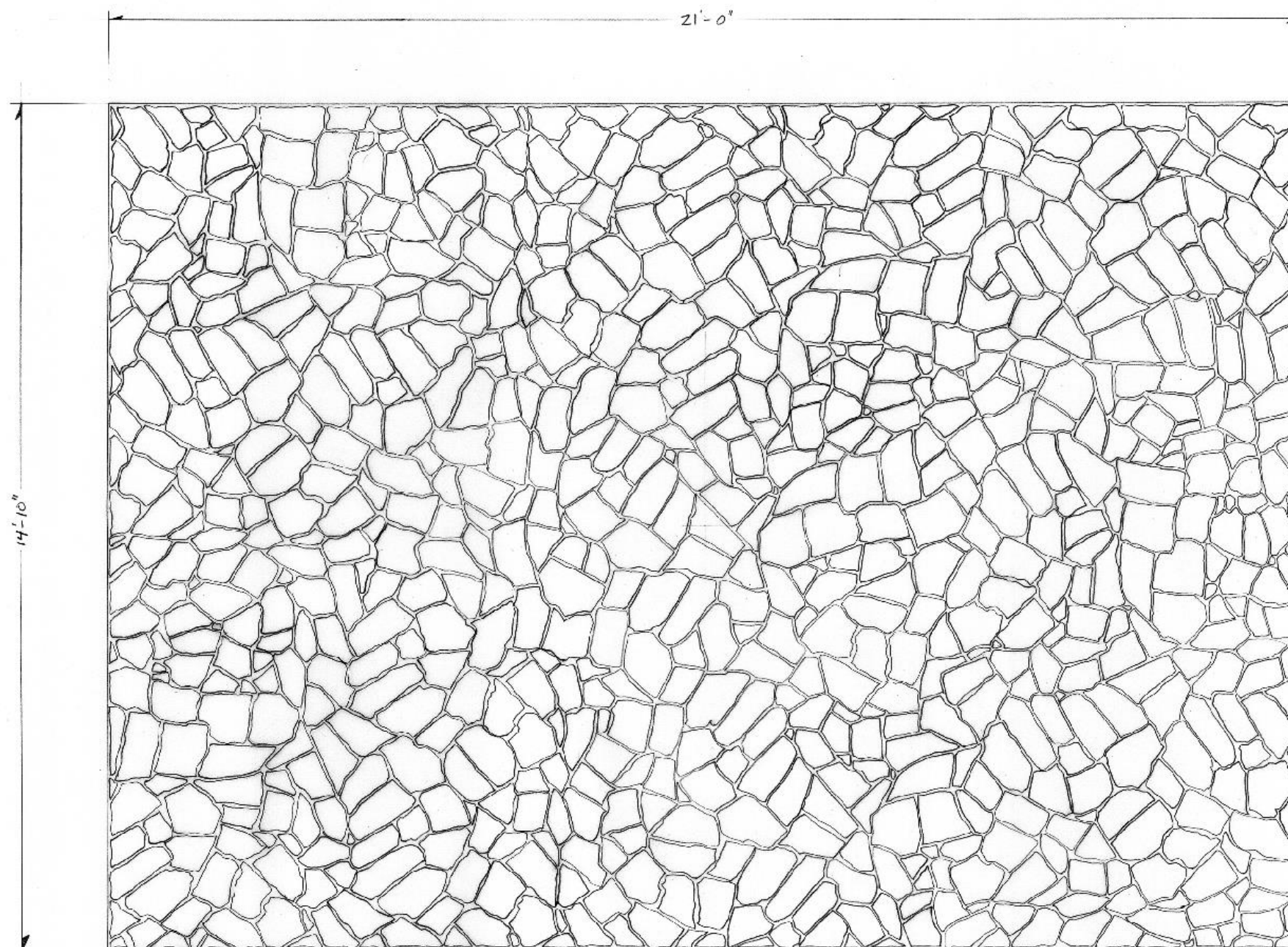

VANYA + BONIA + MASHA + SPIKE	
LNU - BARNELLE THEATRE	
DATE:	DECK DETAIL
12.15.15	
SCALE:	DIR: DANA RESNICK DES: T. JEFFERS
3/4" = 1'-0"	
SHEET:	
4 of 5	

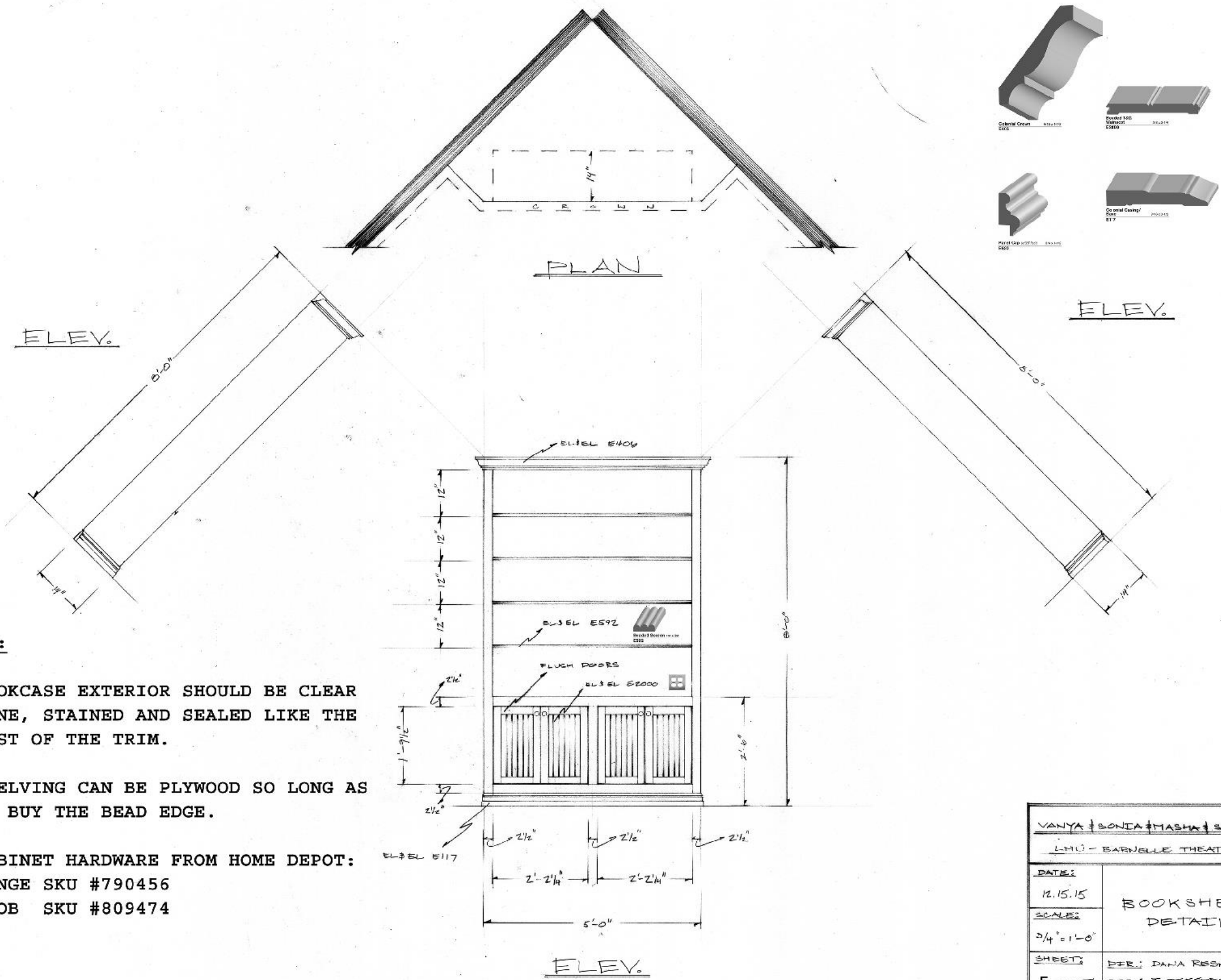

NOTES:

1. BOOKCASE EXTERIOR SHOULD BE CLEAR PINE, STAINED AND SEALED LIKE THE REST OF THE TRIM.
2. SHELVING CAN BE PLYWOOD SO LONG AS WE BUY THE BEAD EDGE.
2. CABINET HARDWARE FROM HOME DEPOT:
HINGE SKU #790456
KNOB SKU #809474

VANYA + SONIA + MASHA + SPIKE	
LMO - BARNQLE THEATRE	
DATE:	BOOKSHELF DETAIL
12.15.15	
SCALE:	
3/4" = 1'-0"	
SHEET:	DES: DANA RESNICK
5 of 5	DES: T. JEFFERS

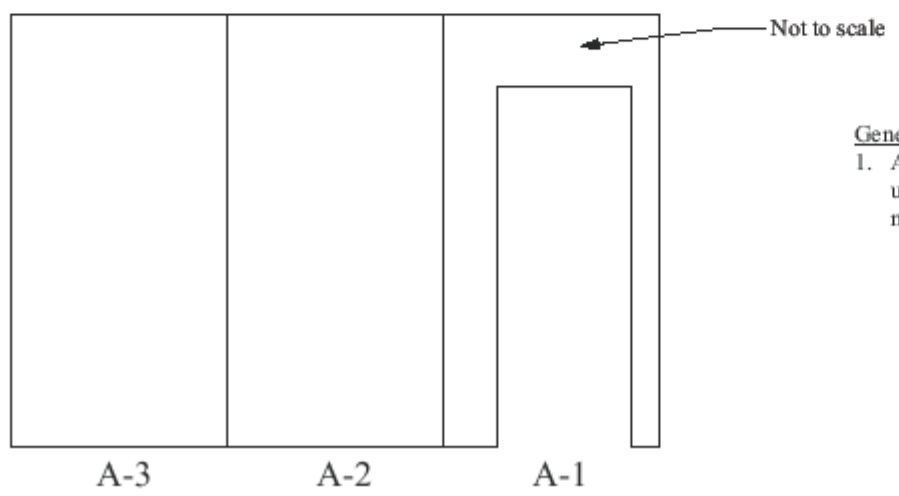
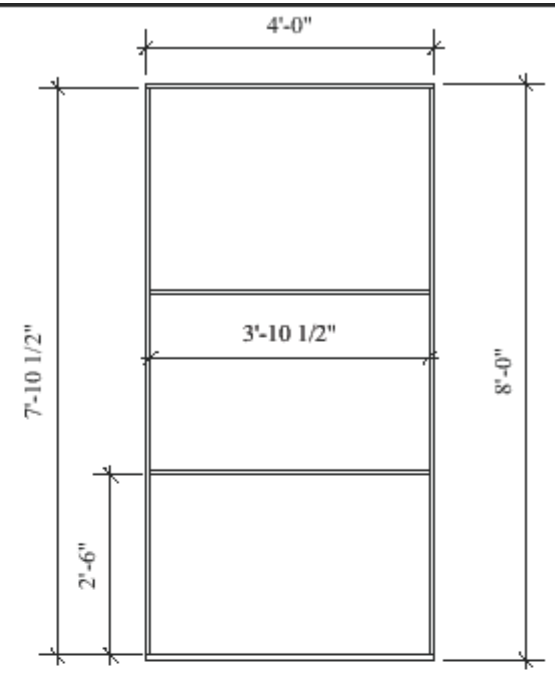
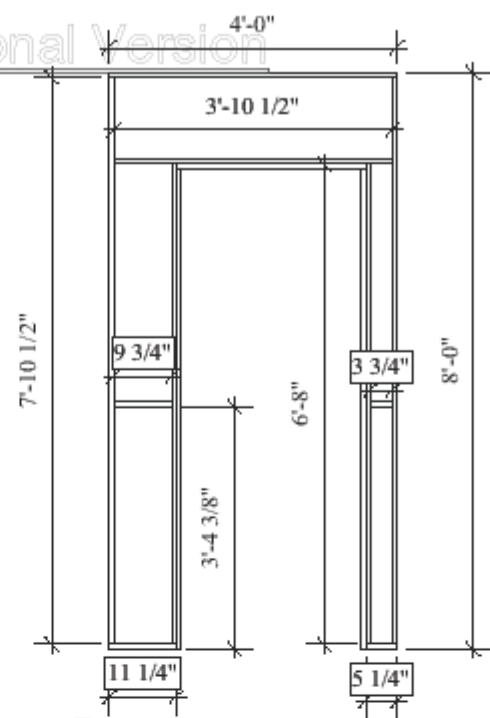
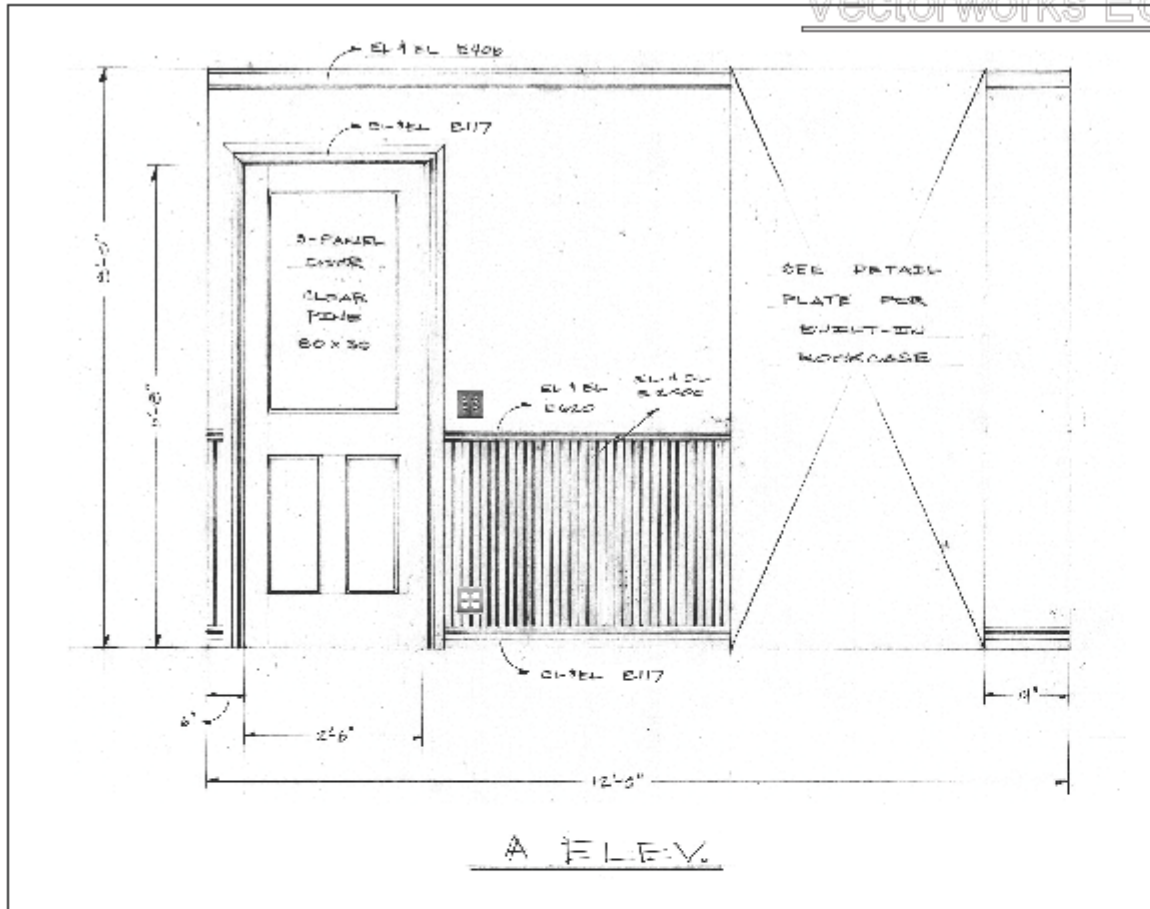

General Notes
1. A-3 is extra and doesn't need to be built until after the bookshelf is installed if its needed

Production Title		Vayna & Sonia & Masha & Spike	
Drawing Title		A Elevation Technical Drawings	
Designer	Tristan Jeffers	Director	Dana Resnick
Drawn By	Tom Ash	Scale	1/2"=1'-0"
Vendor	LMU - Bamelle Theatre	Drawing No.	1 of Total Sheets
Date	00/00/00		
CAD File Name	Filename		

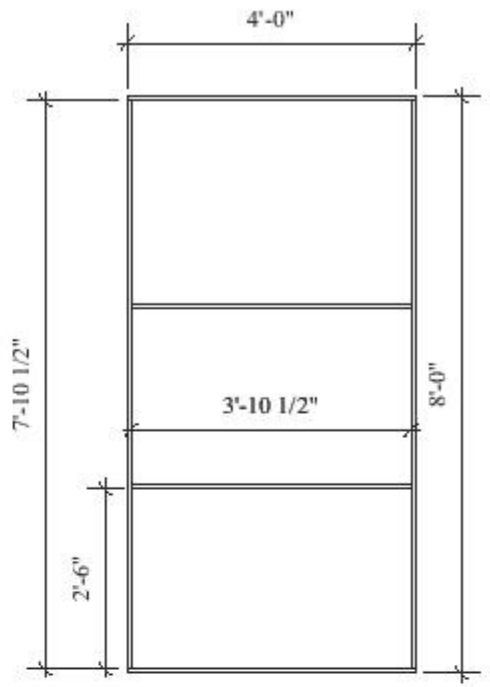
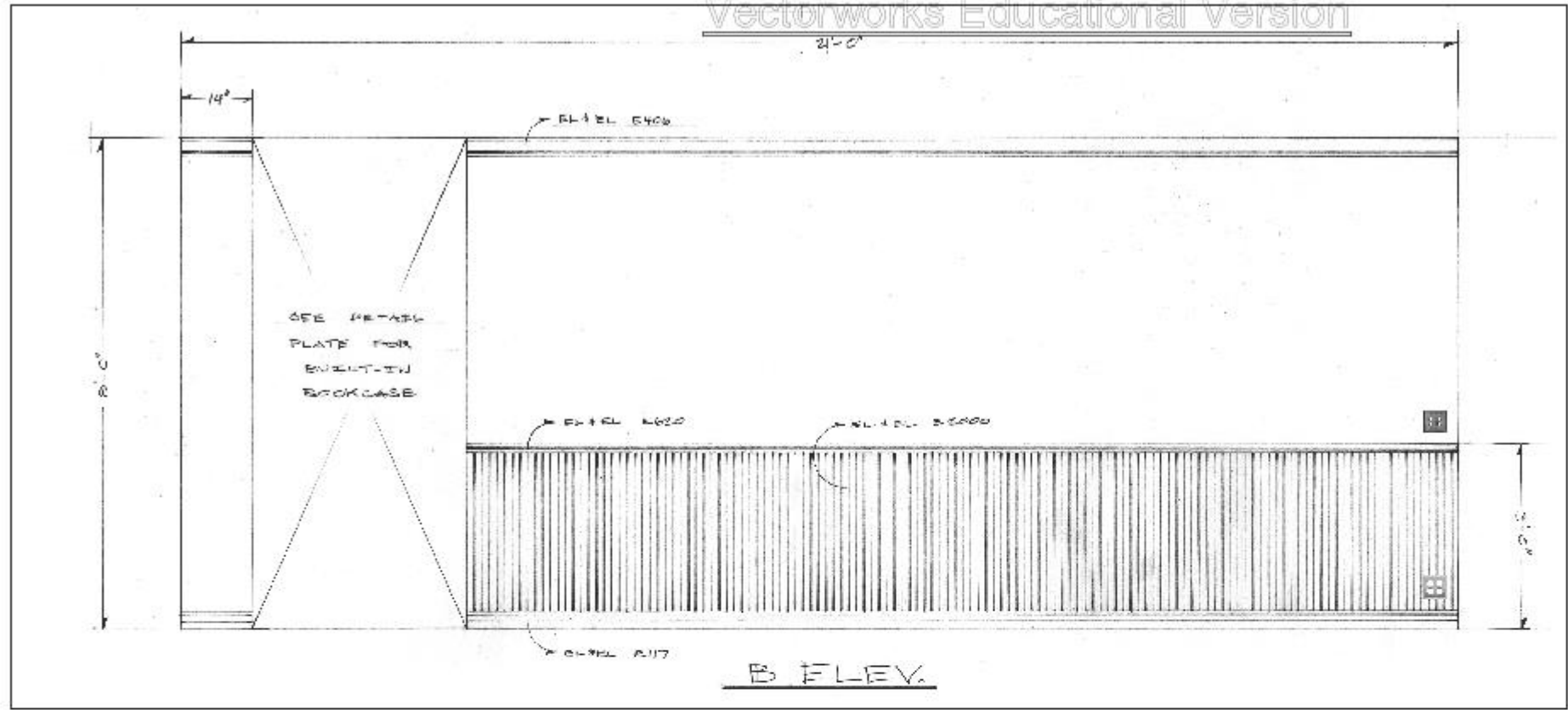

1 B-1,2,3,4,5 Technical Drawing
Scale: 1/2" = 1'-0"

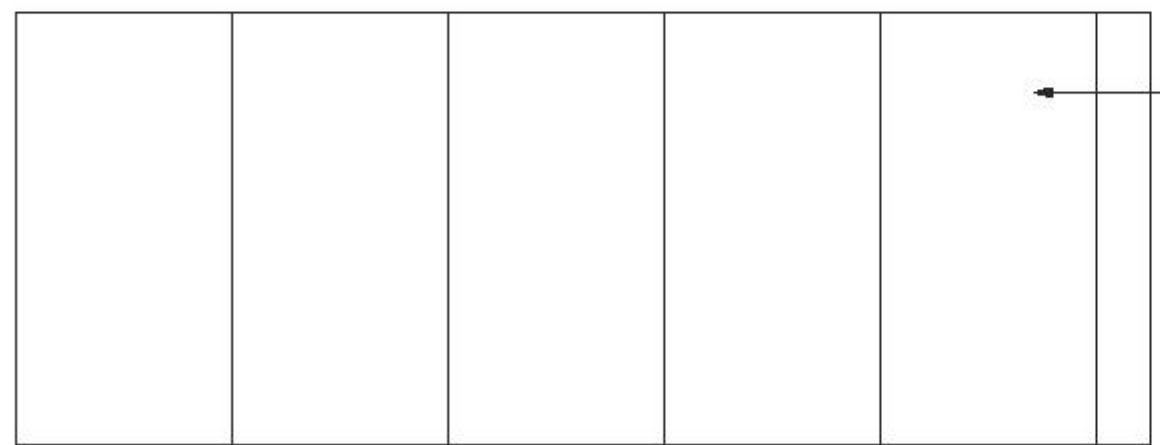

B-1 B-2 B-3 B-4 B-5

Production Title		Vayna & Sonia & Masha & Spike	
Drawing Title		B Elevation Technical Drawings	
Designer	Tristan Jeffers	Director	Dana Resnick
Drawn by	Tom Ash	Scale	1/2" = 1'-0"
Venue	LMU - Banelle Theatre	Drawing No.	2
Date	00/00/00		of
CAD File Name	Filename		Total Sheets

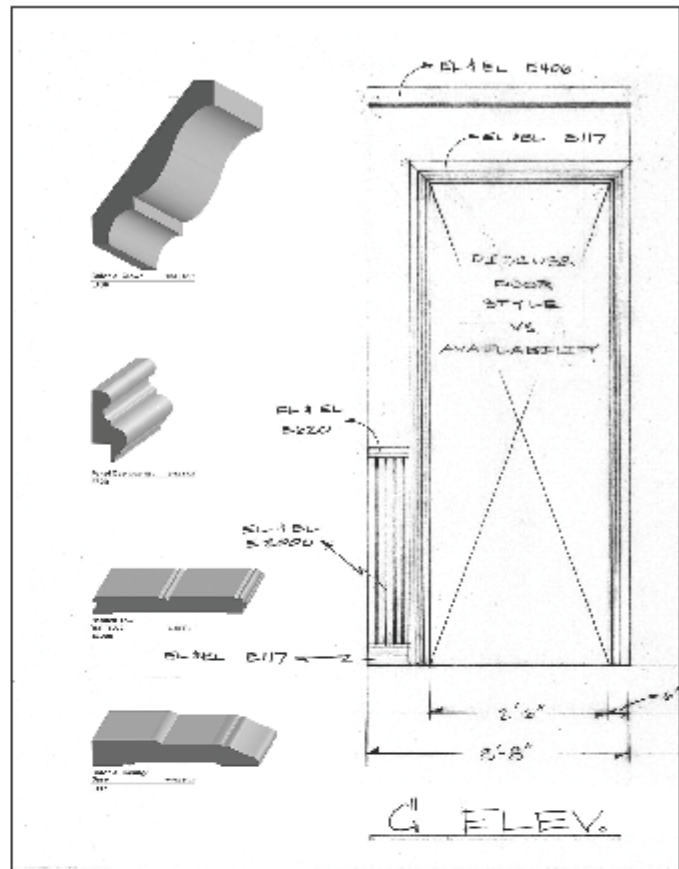
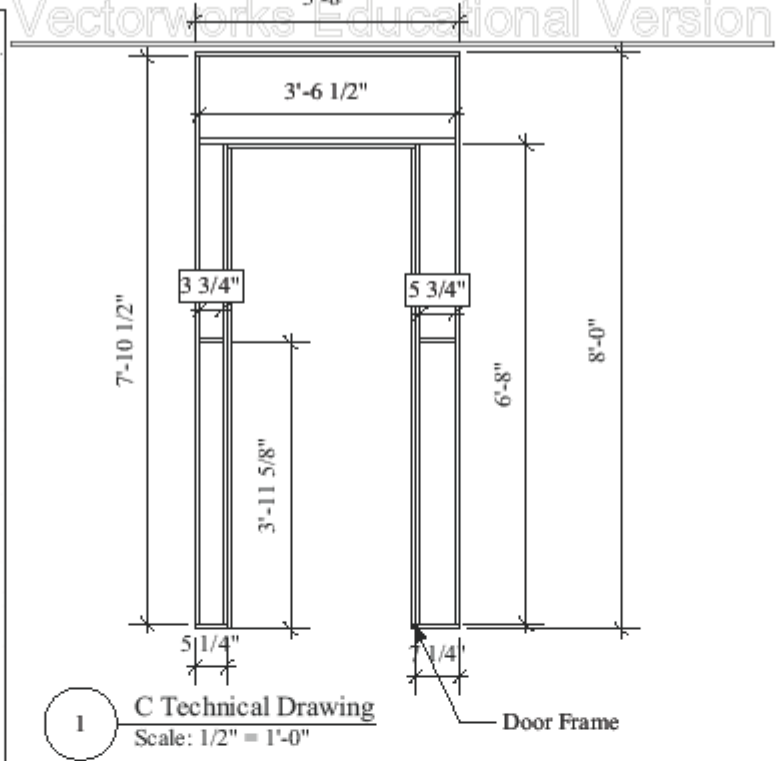
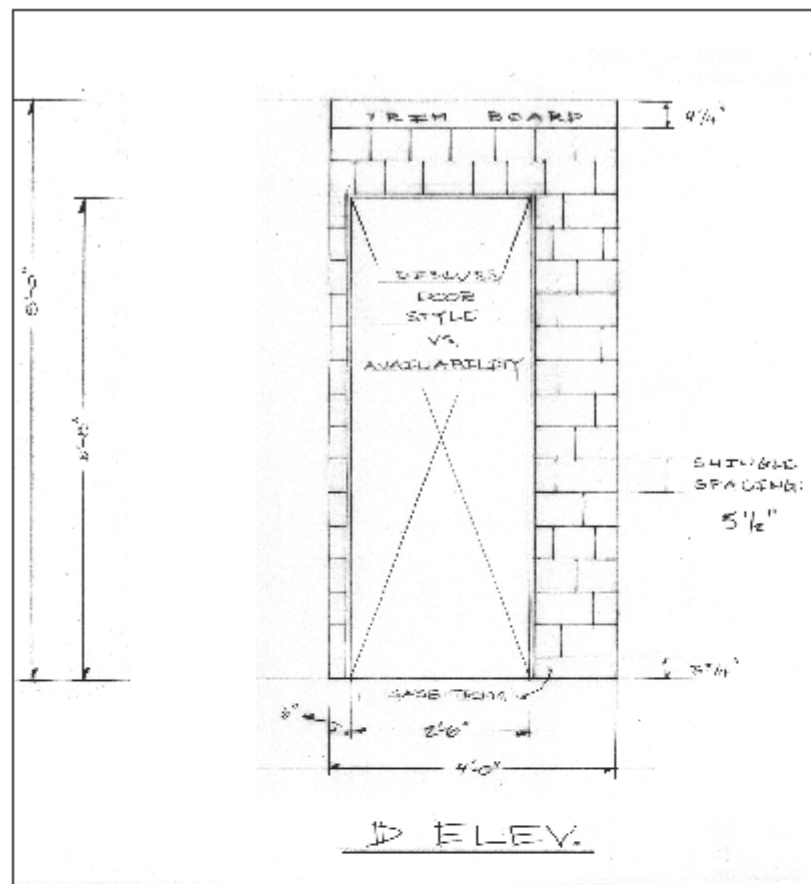

General Notes
 1. Skin both sides of C

Production Title		Vayna & Sonia & Masha & Spike	
Drawing Title		C & D Elevations Technical Drawings	
Designer	Tristan Jeffers	Director	Dana Resnick
Drawn by	Tom Ash	Scale	1/2" = 1'0"
Vendor	LMU - Bamelle Theatre	Drawing No.	3 of Total Sheets
Date	00/00/00		
CAD File Name	Filename		

General Notes

1. 2x4 in contact with wall. 3/4 round at the front of the 2x4 and lattice pushed up against that.

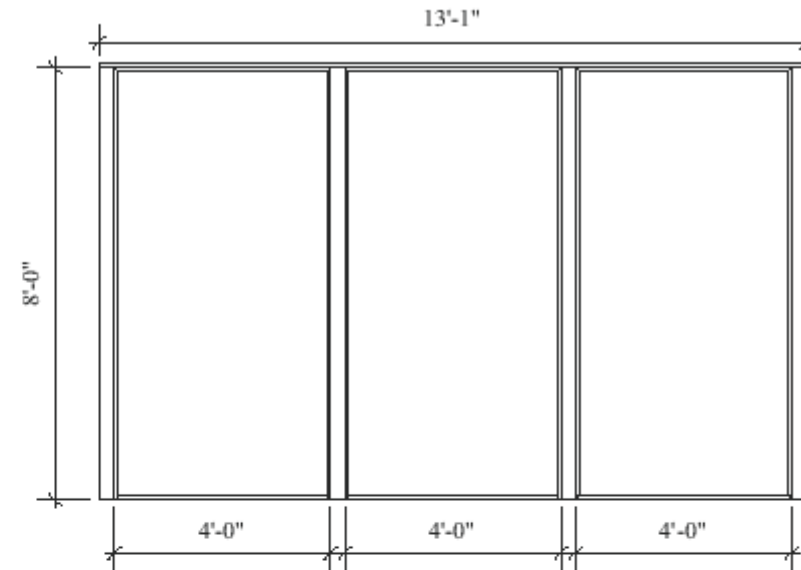

1 E Technical Drawing
Scale: 3/8" = 1'-0"

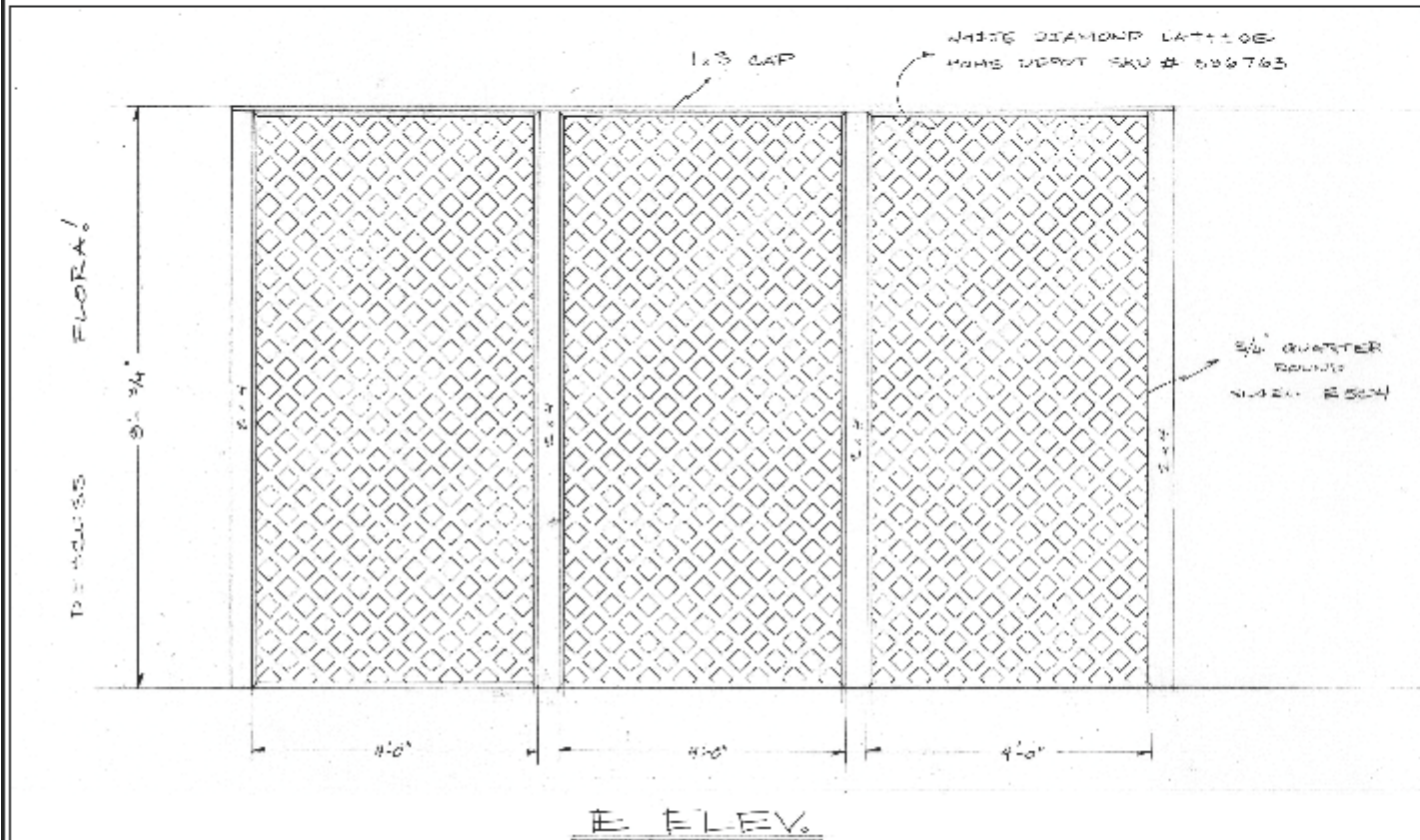

E ELEV.

Production Title		Vayna & Sonia & Masha & Spike	
Drawing Title		E Elevation Technical Drawings	
Designer	Tristan Jeffers	Director	Dana Resnick
Drawn By	Tom Ash	Scale	1/2" = 1'0"
Venue	LMU - Bamelle Theatre	Drawing No.	4
Date	00/00/00		of
CAD File Name	Filename		Total Sheets



11360 W. Pico Blvd
Los Angeles, CA 90064
(310) 479-0324
Fax (310) 479-1916

541 N. Robertson Blvd
West Hollywood, CA 90069
(310) 852-0202
Fax (310) 852-3010

1301 N. Highland Avenue
Hollywood, CA 90238
(323) 464-1600
Fax (323) 484-9997

CUST NO: *30051 JOB NO: 000 PURCHASE ORDER: SHOP REFERENCE: PO # SHOP EST# TERMS: CASH/CHECK/BANKCARD CLERK: AQUINO DATE / TIME: 1/8/16 1:55

SOLD TO:
FRANK SHEPPARD
310-428-7815

SHIP TO:
FRANK SHEPPARD
ONE LMU DRIVE
LOS ANGELES CA 90045

DUE DATE: 1/9/16 TERMINAL: 600
ESTIMATE: 166477
SALESPERSON: 16 DARRELL OUBRE
PICO TAXABLE 26.04
CA LUMBER ASMNT S 2.89

INVOICE: B66498/1

LINE	SHIPPED	ORDERED	UM	SKU	DESCRIPTION	SUGG	UNITS	PRICE/ PER	EXTENSION
1		12	PC	138F	1 X 3 X 8' SELECT DOUG FIR		96	0.29 /LF	27.84
2		8	PC	148F	1 X 4 X 8' SPF OR DOUGLAS FIR		64	0.35 /LF	22.40
3		5	PC	482L	4X8X1/4 LAUAN PLYWOOD		5	15.99 /PC	79.95
4		5	PC	1316CP	1X3X16' C&BTR CLEAR PINE		80	1.19 /LF	95.20
5		2	PC	482AC	4X8 5 MM OR 1/4 ACX PLYWOOD		2	31.99 /PC	63.98
6		1	EA	CTG	DLV CHG-CURBSIDE DELIVERY ONLY		1	65.00 /EA	65.00 *
7					DELIVERY DATE 1/11/16 MONDAY				
8					CALL BEFORE DELIVERY				

REPRINT

** PAID IN FULL ** 389.15 TAXABLE 354.37
NON-TAXABLE 0.00
SUBTOTAL 354.37

TAX AMOUNT 34.78
TOTAL 389.15

*30051
TOT WT: 199.76
MID: 191200661889

B66498/1

BANKCARD PAYMENT
BKCRD# XXXXXXXXXXXXX5885

APP: 000463 XR: 166498

xDelivery
Received By



11360 W. Pico Blvd
Los Angeles, CA 90064
(310) 479-0324
Fax (310) 479-1916

541 N. Robertson Blvd
West Hollywood, CA 90069
(310) 852-0202
Fax (310) 852-3010

1301 N. Highland Avenue
Hollywood, CA 90238
(323) 464-1600
Fax (323) 484-9997

CUST NO: *30051 JOB NO: 000 PURCHASE ORDER: E. HALL THEATER REFERENCE: PO # E. HALL THEA TERMS: CASH/CHECK/BANKCARD CLERK: AQUINO DATE / TIME: 12/10/15 1:56

SOLD TO:
FRANK SHEPPARD
310-428-7815

SHIP TO:
FRANK SHEPPARD
ONE LMU DRIVE
LOS ANGELES CA 90045

DUE DATE: 12/11/15 TERMINAL: 600
ESTIMATE: 136985
SALESPERSON: 02 WILFREDO AQUINO
PICO TAXABLE 36.98
CA LUMBER ASMNT S 4.11

INVOICE: B37000/1

LINE	SHIPPED	ORDERED	UM	SKU	DESCRIPTION	SUGG	UNITS	PRICE/ PER	EXTENSION
1		9	PC	486CD	4X8 23/32 OR 3/4" CDX PLYWOOD**		9	26.99 /PC	242.91 *
2		50	PC	248F	2X4X8' STD&BTR STUD/GRD GRN DF**		400	0.42 /LF	168.00 *
3		1	EA	CTG	DLV CHG-CURBSIDE DELIVERY ONLY		1	65.00 /EA	65.00 *
					SPECIAL ORDERS ARE NOT RETURNABLE!!!!				

REPRINT

** PAID IN FULL ** 522.85 TAXABLE 475.91
NON-TAXABLE 0.00
SUBTOTAL 475.91
(FRANK SHEPPARD)

TAX AMOUNT 46.94
TOTAL 522.85

*30051
TOT WT: 1323.00
MID: 191200661889

B37000/1

BANKCARD PAYMENT
BKCRD# XXXXXXXXXXXXX5885

APP: 086300 XR: 137000

xDelivery
Received By



